

# PORTLAND'S PREMIER CONDOMINIUM RESIDENCE

| Floor/Unit | 01        | 02        | 03        | 04        | 05        | 06        | 07        | 08        |
|------------|-----------|-----------|-----------|-----------|-----------|-----------|-----------|-----------|
| 1          | \$379,000 | \$379,000 | \$365,000 | \$335,000 |           |           | \$310,000 | \$285,000 |
| 2          | \$397,000 | \$397,000 | \$379,000 | \$349,000 | \$335,000 | \$335,000 | \$319,000 | \$379,000 |
| 3          | \$397,000 | \$397,000 | \$379,000 | \$349,000 | \$335,000 | \$335,000 | \$319,000 | \$379,000 |
| 4          | \$397,000 | \$397,000 | \$379,000 | \$349,000 | \$335,000 | \$335,000 | \$319,000 | \$379,000 |
| 5          | \$435,000 | \$435,000 | \$418,000 | \$383,000 | \$365,000 | \$365,000 | \$348,000 | \$418,000 |
| 6          | \$435,000 | \$435,000 | \$418,000 | \$383,000 | \$365,000 | \$365,000 | \$348,000 | \$418,000 |
| 7          | \$435,000 | \$435,000 | \$418,000 | \$383,000 | \$365,000 | \$365,000 | \$348,000 | \$418,000 |
| 8          | \$435,000 | \$435,000 | \$418,000 | \$383,000 | \$365,000 | \$365,000 | \$348,000 | \$418,000 |
| 9          | \$475,000 | \$475,000 | \$455,000 | \$415,000 | \$399,000 | \$399,000 | \$405,000 | \$455,000 |
| 10         | \$475,000 | \$475,000 | \$455,000 | \$415,000 | \$399,000 | \$399,000 | \$405,000 | \$455,000 |
| 11         | \$495,000 | \$495,000 | \$475,000 | \$435,000 | \$415,000 | \$415,000 | \$425,000 | \$475,000 |
| 12         | \$495,000 | \$495,000 | \$475,000 | \$435,000 | \$415,000 | \$415,000 | \$425,000 | \$475,000 |

Contact Downeast Realty for availability.

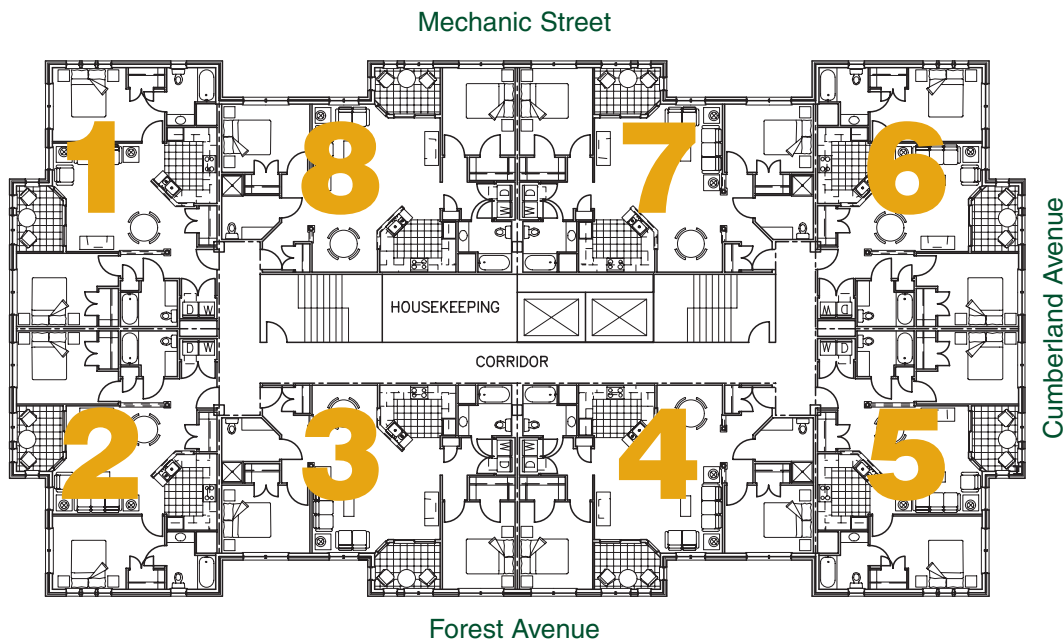

# Waterview at Bayside